

**Melwood LNR and Mel Meadow**

**Summary Management Plan**

**2021 – 2025**

## CONTENTS

|                               | <b>SECTION</b>          | <b>PAGE NUMBER</b> |
|-------------------------------|-------------------------|--------------------|
| Executive Summary             | 1                       | 3                  |
| Summary Management Plan       | 2                       | 6                  |
| Site Details                  | 2.1                     | 6                  |
| Site Description              | 2.2                     | 7                  |
| Site Sub-Divisions            | 2.3                     | 8                  |
| Objectives                    | 2.4                     | 9                  |
| Achievements                  | 2.5                     | 11                 |
| Main Management<br>Operations | 2.6                     | 12                 |
| Appendix 1                    | Management<br>Ideas     | 16                 |
| Appendix 2                    | Species Lists           | 19                 |
| Appendix 3                    | Maps                    | 21                 |
| Appendix 4                    | Management<br>Structure | 26                 |
| Appendix 5                    | Work Plan               | 27                 |

## List of Appendices

**Appendix 1:**

Summary of structure management ideas.

**Appendix 2:**

Species list for Melwood and Mel Meadow.

**Appendix 3: Site Maps:**

*Map 1:* Melwood and Mel Meadow Location Plan. This location plan shows the extent of the area and its relationship to adjacent woodlands, arable fields, school grounds, the railway line, waste water treatment works and the river.

*Map2:* Melwood and Mel Meadow Habitat Plan. This shows some habitat details of the site. It needs to be updated as it is not based on recent survey.

*Map 3:* Map of Tree Protection Orders (provided by South Cambridgeshire District Council)

*Map 4:* OS map 1887: Extent of orchards in Meldreth.

*Map 5:* Inclosure Award Map of Meldreth (1821).

**Appendix 4:**

Management structure of the Melwood Conservation Group.

**Appendix 5:**

Work Plan 2021 to 2025

# **1 Executive Summary**

## **1.1 Introduction**

This plan updates the one prepared for the period 2016 to 2020.

The issues to be addressed and the key objectives for 2021 to 2025 are considered to be very similar to the previous period and therefore this document is primarily focused on a new work schedule for the period 2021 to 2025, with a reiteration of the description of the site, challenges and objectives.

A summary of the achievements 2016 to 2020 is included.

The plan covers the Melwood Local Nature Reserve plus an adjoining strip of land known as Mel Meadow. Mel Meadow incorporates an area of restored grassland which is essentially a woodland glade (see Map 2, (Habitats)).

This small area (2 acres) of woodland habitat forms part of a larger area of woodland along the River Mel. Management by the owners of these areas is largely passive. It supports a number of woodland and grassland plants, insects, birds and bats, and may be used as a refuge area by river species such as water shrew, water vole and otter. Three old hedge lines are still visible as lines of mature trees (see Map 3, Tree protection).

The site is very popular with local people. It is particularly well used by dog walkers and is regularly visited by the local primary school children for supervised activities.

A group of conservation volunteers follow the management plan schedule of activities at work parties during the year.

Events for the public are held in the wood.

## **1.2 Management Challenges:**

- The wood is very small, publicly visible and well-used. It has limited opportunities for tree work or ride creation;
- Many of the trees are similar in age meaning that the ground is very shaded, with a relatively poor cover of woodland plants, and few saplings survive apart from those of Ash and Sycamore which grow in abundance;
- The diversity of grassland plants in the meadow is limited by the shade of nearby trees. Shorter trees or shrubs at the edge of the meadow would allow more light in but the felling necessary to achieve this is not practical, nor likely to be acceptable to the local public.

- Two of the old hedge lines are protected with Tree Protection Orders so any work on these trees must be done in consultation with South Cambridgeshire District Council. The trees in the hedge lines are older and larger than most in the rest of the wood; some cast a considerable amount of shade;
- Public use means that there are many well-trodden paths and very few inaccessible areas;
- As a local nature reserve, the woodland owners wish to engage with the local community and involve more people in managing and enjoying the wood.

### **1.3 Management Operations:**

- Work on a relatively small number of trees to increase light reaching the woodland floor and Mel Meadow. This will be spread over a number of years. Details are in Appendix 1, Potential Open Areas This will allow more plants and shrubs to grow under the trees, which will in turn benefit insects and butterflies. Concentrating on a few small areas will allow maximum benefits with minimum tree work and will increase the diversity within the wood;
- Methods used will be a combination of coppicing (felling and allowing the stumps to re-grow), pollarding (similar to coppicing but leaving a length of tree trunk standing), crown reduction (removing a few large, shading branches) and very limited felling (not allowing the tree to re-grow);
- Planting of trees, shrubs, tubers, bulbs, etc. and distribute seed (purchased if necessary) where appropriate, to facilitate the objectives of the management plan;
- Maintain a circular path, including the public footpath, and discourage use of other paths. Concentrating public use in particular areas will keep them open and allow others to become denser and more secluded;
- Manage the meadow by annual mowing, removing the cuttings. As this area is privately owned the conservation Group does not currently have full control of cutting schedule. It may be possible to use the cuttings to add seed to newly sunny areas of the meadow or paths;
- Provide information, undertake publicity, and work with Meldreth Primary School to increase local knowledge and understanding of the wood;
- Involve and promote volunteers in the monitoring and management of the wood;
- Work with neighbouring landowners and the River Mel Restoration Group to share information and discuss any shared issues;

The aim of the on-the-ground management work is to encourage some areas to become more dense and shrubby and others more open, light and airy. Ideally some of these areas will be adjacent, so that towards the edge of the meadow or a path, short grass becomes longer grass, then bushes and small trees, then finally tall trees. Once established, this structure is maintained by cutting at varying intervals.

Allowing more light to the meadow will allow the grassland plants to spread more extensively and increase the meadow's wildlife value. Currently, the western side of the meadow receives significantly more sun than the eastern side and future management will need to work with this.

## 2 Summary Management Plan 2021-2025

### 2.1 Site Details:

|                           |  |
|---------------------------|--|
| Name:                     | Melwood Local Nature Reserve and Mel Meadow  |
| Area:                     | 0.81 Ha (2 acres)  |
| Grid Reference:           | TL378459   |
| Local Planning Authority: | South Cambridgeshire District Council  |
| District:                 | South Cambridgeshire   |
| Conservation Status:      | Tree Protection Orders on some trees.<br>Melwood is officially recognised as a Local Nature Reserve.   |
| Nature of legal interest: | Cambridgeshire County Council owns Melwood. Meldreth Parish Council is the leaseholder of Melwood. The adjacent Mel Meadow is owned by Miss Margaret Hunter.<br><br>South Cambridgeshire District Council has protected two of the old hedge lines with Tree Protection Orders. Any work on these trees must first have consent from the District Council. |
| Current Management:       | Melwood Conservation Group carries out the practical management of Melwood and Mel Meadow. Miss Hunter also carries out some independent management on the site. Miss Hunter has kindly arranged that Mel Meadow will ultimately become part of the LNR.   |
| Byelaws:                  | None at present.   |
| Access:                   | The adjacent public footpath (Footpath Number 6 on the definitive map) provides open access to the woodland which is available to the public at all times. The nearest entrance is via the footbridge at the end of Flambards Close.   |

## 2.2 Site Description

Melwood is a small woodland nestled in the village of Meldreth in South Cambridgeshire. The OS map published in 1887 shows that Melwood was one of the few fields in the area not planted as an orchard. As Melwood formed part of the same parcel of land as Meldreth village school at enclosure, it is possible that regular grazing may have ceased when the school was built in 1910. This would have resulted in the gradual encroachment of the grassland by scrub, leading to the development of secondary woodland. The old hedge lines were clearly marked as field boundaries on the Inclosure Award Map of 1820.

By the late 1970s and early 1980s, the woodland had become increasingly dominated by scrub to the detriment of ground flora.

A conservation group was formed in 1986 by Miss Hunter, the owner of Mel Meadow. Volunteers cut back dense thickets of scrub to enable light and air to enter the woodland again. New trees were planted, some of which were native species (such as hazel, field maple and beech) and some of which were non native species (such as ornamental cherries). Further planting has continued during 2016 to 2020. These are listed in 2.5.1

The site forms part of a larger, linear woodland along the east bank of the river. This larger wood is owned by a number of different landowners and consists mainly of former orchards, with some damper areas and a variety of trees including willow. Management by the owners of these areas is largely passive, although there has been clearance at the back of the village Pub and adjacent areas and at the back of the new High Street development.

The River Mel is a spring-fed chalk stream which flows into the River Cam (or Rhee) 2 to 3km downstream and forms an important wildlife corridor. The River Mel Restoration Group, a group of local volunteers, manages the river.

Secondary woodlands such as Melwood, which are near to towns or villages, often have a history of use by local people for informal recreation and play. Such woodlands have more direct value to society than biologically rich but remote ancient woodland with no public access. These woodlands, even very small ones, provide areas for recreation and relaxation and can sometimes be the only accessible 'wild' space for play, learning and adventure that local children may have. Many secondary woodlands, including Melwood, are ecologically robust. The fact that they may contain fewer of the sensitive and specialist species that occur in ancient woodland means that the woodlands themselves are less sensitive to the pressures of recreational use and as such have a higher carrying capacity in terms of visitor usage before unacceptable ecological damage is done.

High levels of public use have led to the existence of many well-worn paths through the wood. The woodland is directly adjacent to

a public right of way which runs alongside the river for approximately 1 km.

Melwood is well used by the public and forms a significant public amenity for the village, particularly for regular dog walkers.

The site is regularly visited by the local primary school children for supervised activities.

Groups of younger people gather in one particular area near the ditch and occasionally light fires and leave litter. These visits have decreased in recent years, perhaps as a result of encouraging young people to appreciate the wood whilst in Primary School.

The conservation group maintains a litter rota and it is encouraging that the quantity of this in the wood has decreased, although dog poo is still a problem. Articles are regularly written in the local village magazine, Meldreth Matters, to highlight this issue amongst others.

## **2.3 Site Sub Divisions**

The site, although small, is sub-divided into areas that reflect the habitats present; these are used as management compartments within the plan.

### **Area – H1 Secondary Woodland**

Secondary woodland covers most of the site (age estimated 40 – 100 years). The habitat community is typical of the area, dominated by ash and sycamore with hawthorn and elder beneath. It includes several non-native species such as ornamental cherry. Native trees and plants support a greater diversity of fungi and invertebrates than non-native species, which in turn will support a greater number of insect-eaters such as birds and bats. The woodland has a dense canopy and many narrow paths, resulting in a limited ground flora. In some areas ivy dominates the ground cover while in others there are areas of sedge and ground ivy with extensive patches of dog's mercury. There is also dog's mercury at the rear of the meadow. There are also planted daffodils and bluebells, some of which are non-native. There are signs of heavy rabbit grazing, and Muntjac deer are known to be present limiting species diversity.

### **Area – H2 Ancient hedgerows**

Three parallel old hedge lines run southwest to northeast, which are now lines of large ash and hawthorn trees and form the site boundary on two sides. There is evidence that these trees have been coppiced in the past.

### **Area - H3 Meadow**

There is a meadow area known as Mel Meadow. The south-western end of Mel Meadow has an area of cleared land which has been seeded with grass and meadow plants. For management purposes this may be thought of as

part of the woodland habitat, as it is essentially a woodland glade, although it lacks any marginal growth typical of glades.

### **Area – H4 River**

The River Mel forms the south-west boundary to the site. The River Mel Restoration Group is working to restore the river and improve its biodiversity. River species such as otter, water vole and water shrew are known to be present and may also benefit from the habitat in Melwood and Mel Meadow. A ditch forms the eastern boundary and contains water seasonally.

## **2.4 Objectives:**

### **2.4.1 To maintain and enhance the different habitats of the site**

#### **H1 & H2 Secondary woodland**

Woodland management will increase the variation in woodland structure. Tree work such as coppicing (cutting down and allowing to re-grow) will produce gaps (effectively glades), which allows more light in and encourages regenerations and a flush of growth. This in turn provides habitat for a wide range of birds, animals and insects.

A varied habitat will attract a greater variety of plants and animals and therefore have a greater wildlife value. This means having variety in the age and height of trees, including dead wood, as well as the amount of light and shade. Many species of bird and insect thrive in the transitional areas at woodland edges where increased sunlight allows more flowers and berries to grow. Similar habitat may be created at the edges of woodland paths or glades. Dead wood provides a home for wildlife including bats, birds, fungi, lichens and mosses as well as a large range of insects. Standing deadwood and fallen trees provide different habitats, as do the rot-holes and hollows in older living trees. Ivy on trees provides nest sites, winter shelter and food for birds and insects. As ivy flowers late in the year, it provides nectar when little else is available.

Because the site is a Local Nature Reserve and so the local community is encouraged to visit, there may be a need for additional intervention if trees become a safety risk to visitors.

#### **H3 Meadow Management**

The meadow will benefit from work reducing adjacent tree cover. More light reaching ground level will allow more grasses and flowering plants to flourish. East of the meadow flowers, particularly primroses, will be encouraged by reducing ivy growth.

Grassland and grassland plants will be encouraged by annual mowing, removing the cuttings. Green hay from the more flower-rich areas of the meadow may be used to enhance other areas which were previously shaded.

As the area lacks any marginal growth typical of woodland glades this could be developed by establishing a 1-1.5m marginal band along one or both edges of the existing grass. However this area maybe too dry (the best woodland glades in this part of the country are all in water retentive soils). Tall grasses will be suppressed in the area of maximum sunlight by seeding with Yellow Rattle. This will result in the need for different cutting times and methods in this section compared to the main area of the meadow.

#### **H4 River management**

The footpath adjacent to the River Mel is the widest path in the wood.

Work near the river will be done in consultation with the River Mel Restoration Group and the school.

#### **2.4.2 To maintain and enhance the public access of the site for local people**

The site is currently well used by local people for informal recreational activities including walking and observing wildlife.

A circular path around the wood, including the public footpath, has been selected and is maintained. This defined path discourages people from walking in other areas, so that denser growth can establish in places. This path has been delineated in areas by logs and woodchips on the footpath floor.

During the restrictions associated with the corona virus pandemic the paths around the wood have been far more heavily used and new tracks are appearing through the main body of the wood. These will need some unobtrusive discouragement, such as areas of uncontrolled scrub around the margins of the main paths.

#### **2.4.3 To increase involvement of the local community in the management of the site**

An understanding of the work done in the wood and of the long-term aims will reduce the number of complaints from people who use the wood, especially if they feel they have had the chance to express their views. It will also lead to a greater appreciation of the work put in by volunteers. This is partially achieved by regular articles in the local village magazines, Meldreth Matters (monthly) and the neighbouring village Melbourn Magazine (quarterly). As a Local Nature Reserve the success of the site depends on the involvement of local people.

#### **2.4.4 To enhance interpretative/educational opportunities of the site for local people.**

Whilst the site is well used by local people, there is scope to improve awareness of the LNR and encourage its use.

The school is very close to the wood, and the current use by the school is supported. This should introduce the children to the value of the site and about the responsible use of woodland. Achieving an understanding of nature at the primary school level could go a long way to avoiding problems in later years.

#### **2.4.5 To continue to work with the River Mel Restoration Group and others to create a coherent management strategy for Melwood as part of a wider vision**

While Melwood has intrinsic value for wildlife, it is also part of a greater habitat network. Working with the River Group provides the opportunity to look at links between Melwood and the nearby river habitats.

The previous owner of the woodland to the South of Melwood was supportive of the project and has allowed some intervention in his area of woodland, following similar objectives applied to the north-east corner of Melwood (maintain dense tree cover). The new owner is also supportive.

The ownership of the ditch running on the northern boundary has not been established and the Conservation Group wish to ensure that this is not tampered with due to its importance for wildlife.

Attempts to involve local farmers on critical issues should continue, although so far it has not been very successful.

#### **2.4.6 To ensure that the agreed management plan is implemented and record all activities relating to the management plan**

It is important that the detailed operational plan is regularly assessed and updated as necessary.

### **2.5 Achievements 2016 to 2020**

#### **2.5.1 Maintain and enhance the secondary woodland habitat**

- 1 Maps have been produced and kept updated;
- 2 Tree growth has been regularly monitored and appropriate coppicing and felling carried out at work parties;
- 3 Rotating coppicing programme carried out;
- 4 Discouragement of random paths through the wood has been fairly successful. Installation of log borders and wood chippings have helped;

- 5 A number of trees were planted. 3 were well established pot-grown specimens – Small-leaved Lime, Crab apple and Hornbeam. 2 oak seedlings were planted and 2 bird Cherry bare-rooted suckers were also introduced. All were appropriately supported and protected and are growing well. Additional light may be needed over some of these;
- 6 Native Daffodils and Bluebells have been planted
- 7 Snowdrops have been managed to protect plants from damage at the edge of paths.
- 8 Other herbaceous species have also been successfully introduced along path edges, e.g. Dusky Cranesbill, Nettle-leaved Bellflower and Stinking Iris.
- 9 Nest boxes have been managed and repaired where necessary.

#### **2.5.2 Maintain and enhance the meadow habitat**

- 1 Annual mowing of the meadow;
- 2 Planting and seeding with wild native species.

#### **2.5.3 Involve the local community in the management of the site**

- 1 There is a solid core of regular volunteers and there have been new recruits during this period;
- 2 There have been regular articles in the local magazines, Meldreth Matters and the Melbourn Magazine;
- 3 A litter rota is maintained.
- 4 A film of the river Mel 'Waterlight' in 2019 included a section on the Melwood reserve.

#### **2.5.4 Enhance interpretative/educational opportunities of the site for local people.**

- 1 There was a den building event for the primary school on the site and they now regularly visit as part of their studies;
- 2 Bird walks for the community have been well supported;
- 3 A very successful music and poetry event was held in 2015.

#### **2.5.5 Ensure that the agreed management plan is implemented and record all activities relating to the management plan**

- 1 Activities have been recorded and regular reports provided to committee meetings and the AGM on achievements and future plans,
- 2 The Melwood conservation group hold regular meetings and maintains all documentation relating to the group's activities.

#### **2.5.6 Additional Activities**

- 1 Bird and bat boxes have been maintained and additional ones installed.

### **2.6 Main Management operations for 2021 to 2025**

### **2.6.1 a) Maintain and enhance the secondary woodland habitat**

- Maintain maps as work progresses;
- Continue review of vegetation and Identify areas for further work; thinning, coppicing or planting;
- Carry out further thinning in the back eastern corner to support bush coppicing and / or plantings and ensure good light in cleared areas;
- Carry out annual inspection to identify any trees that are potential safety hazards;
- Maintain circular access path by cutting back over-hanging vegetation and maintaining borders;
- Use wood chips to maintain the condition of the main path and the footpath along the Mel river;
- Selectively control ground ivy by cutting and pulling;
- Encourage new growth of herbaceous plants by green mulch, seeding or planting;
- Maintain litter rota;
- Tree planting with a view to ensuring long-term continuation of the area as woodland.
- Maintain control of dominant ground flora to protect less dominant introduced species. Cut or pull Garlic Mustard and Hedge Parsley after flowering but before seeds are scattered. Pull cleavers before it smothers small trees and bushes;
- Encourage build-up and composting of leaf litter;
- Identify local woodland species that could be introduced where suitable environmental conditions can be found (use of leaf litter etc);
- Consider removal of non-native species where these are invasive or likely to adversely affect related native species. Transplanting to separate native from non-native may be sufficient in some cases, e.g daffodils;
- Control ground ivy by cutting and pulling. Increase light access to cleared areas and mulch or seed to establish grass and sedge as in other parts of the wood.

### **2.6.1b) Maintain and enhance the meadow habitat**

- Ideally cut once per year, although currently the schedule is not under the control of the management committee as this is private land. Review timing annually and decide whether to cut half early and half later.  
Use cuttings as “green hay” to enhance areas of reduced shade following tree work;
- Regularly review hedge lines, particularly western edge.  
Thin crowns rather than fell if more light needed.  
Possibly allow bushes to mature on western edge then introduce hedge plants;
- Annually monitor grass near cut yews and decide if seeding needed:
- Keep control of the Yew hedge to reduce the shade it causes.
- Review regularly enhancement of flora in the meadow area;

- Consider control of long grass in part of the area by seeding with Yellow Rattle. This section will require a specific cutting schedule.

### **2.6.1c) Maintain and enhance the riverside habitat**

- Work with the River Mel Group and the Primary School to identify felling, pollarding, coppicing requirements;
- Keep grasses down on the edge of the bank to encourage flowering plants.

### **2.6.2 Maintain and enhance the public access of the site for local people.**

- Maintain circular access path by cutting back over-hanging vegetation;
- Discourage development of new paths through the heart of the wood by reinforcing log borders, use of wood chippings on the main path and encouraging tough growth over potential breaks from the main path.

### **2.6.3 Involve the local community in the management of the site**

- Continue to recruit and train volunteers, if necessary, to help with the management of the wood and to survey for birds, invertebrates, bats, small mammals and plants;
- Maintain the litter rota;
- Continue to publicise the work of Melwood Conservation Group, for example in the village magazine, as well as opportunities to get involved with work parties.
- Ensure website is referenced in the group's publications.

### **2.6.4 Enhance interpretative/educational opportunities of the site for local people**

- Use temporary boards to explain ongoing major management work;
- Continue to encourage Meldreth Primary school and/or Melbourn Village College to use the woodland as a resource for teaching and recreation. Use these contacts to promote increased understanding of woodland management and ecology amongst the students (i.e. help them understand why the management is taking place, which activities cause damage to the wood and which do not). Possibly carry out transect studies.

### **2.6.5 Continue to work with the River Mel Restoration Group on implementation of the management strategy**

- Discuss any further tree felling/pollarding/coppicing on the river bank.

### **2.6.6 Interact with adjacent land owners when required**

### **2.6.7 Ensure that the agreed management plan is implemented and record all activities relating to the management plan**

- Keep a management diary to record all work done on site;
- Undertake yearly monitoring of site management operations to ensure objectives are being met and to inform future management plan reviews.

#### **2.6.8 Additional maintenance work**

- Nettle control in selected areas of the wood and meadow;
- Dock control on the meadow;
- Cleavers control in the wood, especially around new plantings;
- Support for new plantings, both trees and herbs e.g. watering in periods of prolonged drought.;
- Cow parsley: ensure that this does not reappear and dominate;
- Bird boxes: Clean at the start of the following winter, or remove and repair if necessary;
- Bat boxes: Possibly add more.

# Appendix 1: Summary of structure management ideas

## Existing Open Spaces

- Manage grassland areas within the current constraints of private ownership. Remove all cuttings after mowings;
- Manage all edges on rotation where possible (using a combination of coppice and mowing) to achieve a graded edge.
- Consider re-establishing hedge lines along the side of the meadow. On the wood side this could involve an area of taller vegetation and small bushes. The meadow would be kept shorter by cutting and appropriate planting and seeding.

## Potential Open Areas

Look for opportunities to create glades in these areas, to allow more light to reach the ground. As Melwood has a limited seed bank, it is necessary to let as much light in as possible so that imported seed can establish.

- Reduce crowns and coppice or pollard others to let more light in. Tree removal might also be needed;
- Use seed and/or plug plants (native species, sourced as locally as possible) to establish ground flora;
- Manage edges of the new open spaces as above.

An area at the back of the wood is kept as bare soil for activities by the local primary school children adjacent to a sunny path.

Snowdrops are flourishing on the path leading from the wood to the meadow. This will be encouraged, but with repositioning when they encroach on the path (this stretch of path is privately owned land but managed by the conservation group).

## Denser Growth Area

This consists of three areas; two of younger trees with the central area populated by more mature trees (see map: Appendix 3 Map 2).

Encourage the growth of saplings and understory in this area.

- Choose paths to keep clear and maintain them (and try to make other paths less appealing to walkers);
- Identify and protect saplings (this could involve using tree guards and clearing a small amount of ivy around each);
- Planting for long term continuity, The situation with Ash die back will be monitored. Replacements of diseased Ash will not be with Ash unless disease resistant cultivars become available. Therefore

replacement planting is likely to be similar to recent plantings of Hornbeam, Crab apple, Oak and Bird Cherry;

- One-off coppicing to improve the density of the shrub layer;
- Allow some shrubs and tall vegetation to grow;
- If there is too much shade from tall trees, fell one and allow it to make a hole in the canopy as it falls. Leave all or part of the tree in place as fallen dead wood. Crown reduction could also be used.
- Control, by removal any unwanted sycamore self seedings.

## Hedge Lines and Paths

### Hedges

These include many of the larger trees in Melwood. All but the southeast line are protected with TPOs.

- Continue the restoration of the southeast hedgeline;
- Attempt to increase light onto the path at the south east border by removing ivy and excess branches. Consider coppicing some of the larger trees in the southeast hedge line near the main path, as part of creating a small glade. This will require negotiation with the neighbouring land owner;
- One or two of these trees may be left to lie (with a gap for the path) to provide deadwood habitat;
- Plan whether to re-establish any of the old hedge lines, particularly the meadow end of the two protected ones. This could involve:
  - o Establishing a coppiced area in front of the existing trees along the northwest hedge line (yellow on map);
  - o Coppicing or pollarding some of the existing trees in the middle hedge line (with optional gapping up); or
  - o Planning to plant new trees and establish a hedge in future, once the older trees have died;

### Paths

#### Path 1

Coppice on the west side to widen and develop a low hedge line to discourage paths through the wood.

#### Path 2

Encourage taller vegetation right up to the path edge. Maintain the log borders.

#### Path 3

Continue current maintenance.

Melwood and Mel Meadow Example Management Areas



## Appendix 2: Species lists UPDATE

### Birds

Mallard  
Buzzard  
Sparrowhawk  
Kestrel  
Hobby  
Pheasant  
Moorhen  
Woodcock  
Wood Pigeon  
Collared Dove  
Cuckoo  
Tawny owl  
Swift  
Swallow  
House Martin  
Kingfisher  
Green woodpecker  
Great Spotted  
Woodpecker  
Pied wagtail  
Grey wagtail  
Spotted Flycatcher  
Wren  
Dunnock  
Robin  
Blackbird  
Mistle thrush  
Song thrush  
Fieldfare  
Redwing  
Blackcap  
Chiffchaff  
Goldcrest  
Long-tailed tit  
Blue Tit  
Great Tit  
Jay  
Magpie  
Jackdaw  
Rook  
Starling  
House Sparrow  
Chaffinch  
Green finch  
Gold Finch  
Little Egret

### Trees

Field maple  
Sycamore  
Silver Birch  
Hazel  
Hawthorn  
Ash  
Ivy  
Privet  
Honeysuckle  
Cherry  
Blackthorn  
Red Currant  
Rose (introduced)  
Dog-Rose  
Dewberry  
Bramble  
Elder  
Rowan / Mountain Ash  
Yew  
Beech  
Prunus  
Oak (introduced)

### Mammals

Water Shrew  
Pygmy Shrew  
Yellow necked field mouse  
Wood mouse  
Vole (unidentified)  
Bank Vole  
Water Vole  
Rabbit  
Grey Squirrel  
Fox  
Muntjac deer  
Hedgehog  
Pipistrelle bat  
Mole  
Otter  
Weasel

### Fungi

Morchella esculenta  
Coriolus versicolor  
Hypholoma  
sublateritium  
Xylaria hypoxilon  
Polyporus squamosus  
Psathyrelia  
candolieana  
Auricularia auricula  
Inocybe geophylia  
Calocera cornea  
Armillaria mellea

# Appendix 3: Map 1 – Location

Melwood and Mel Meadow Location Plan

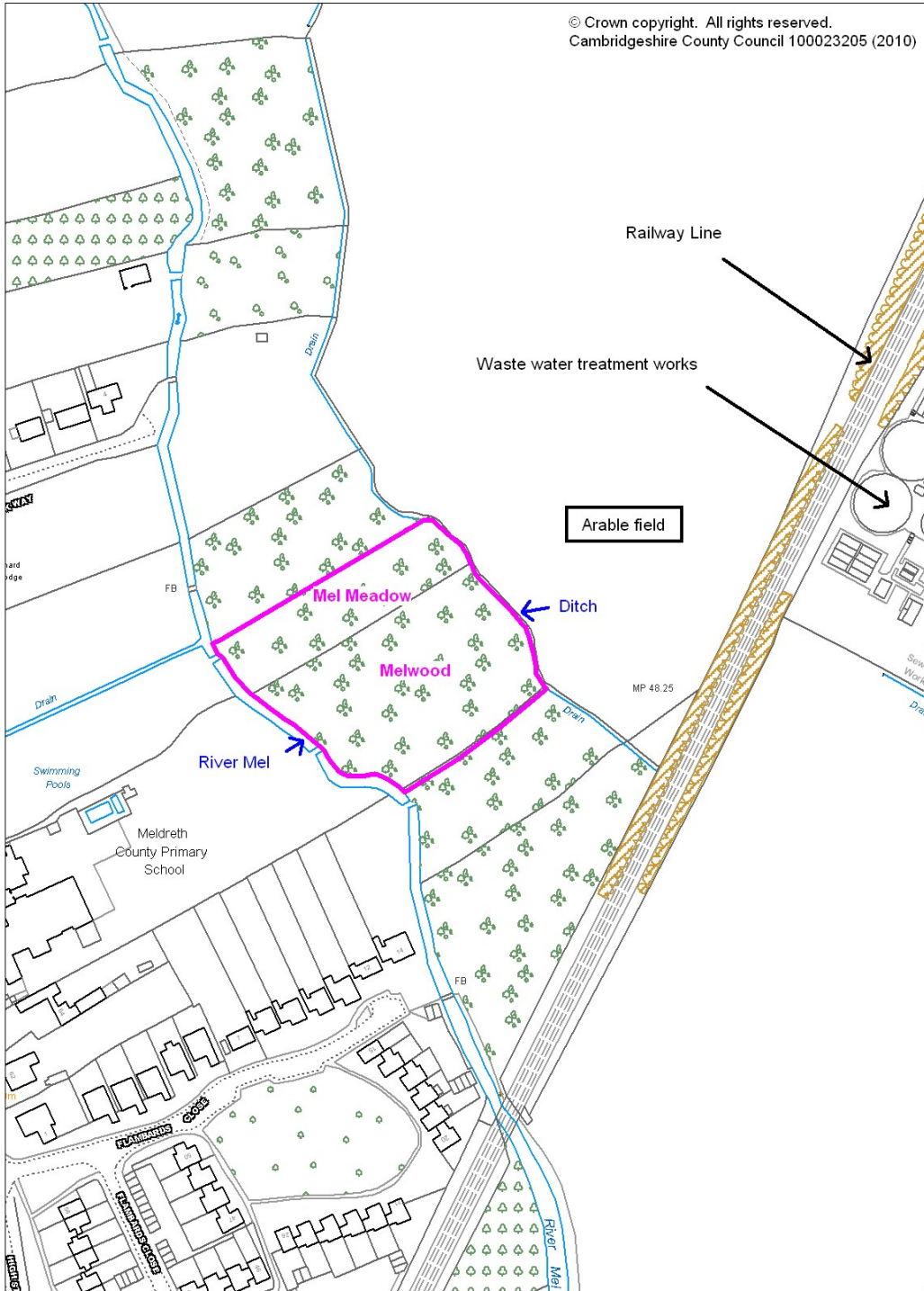

# Appendix 3: Map 2 – Habitats

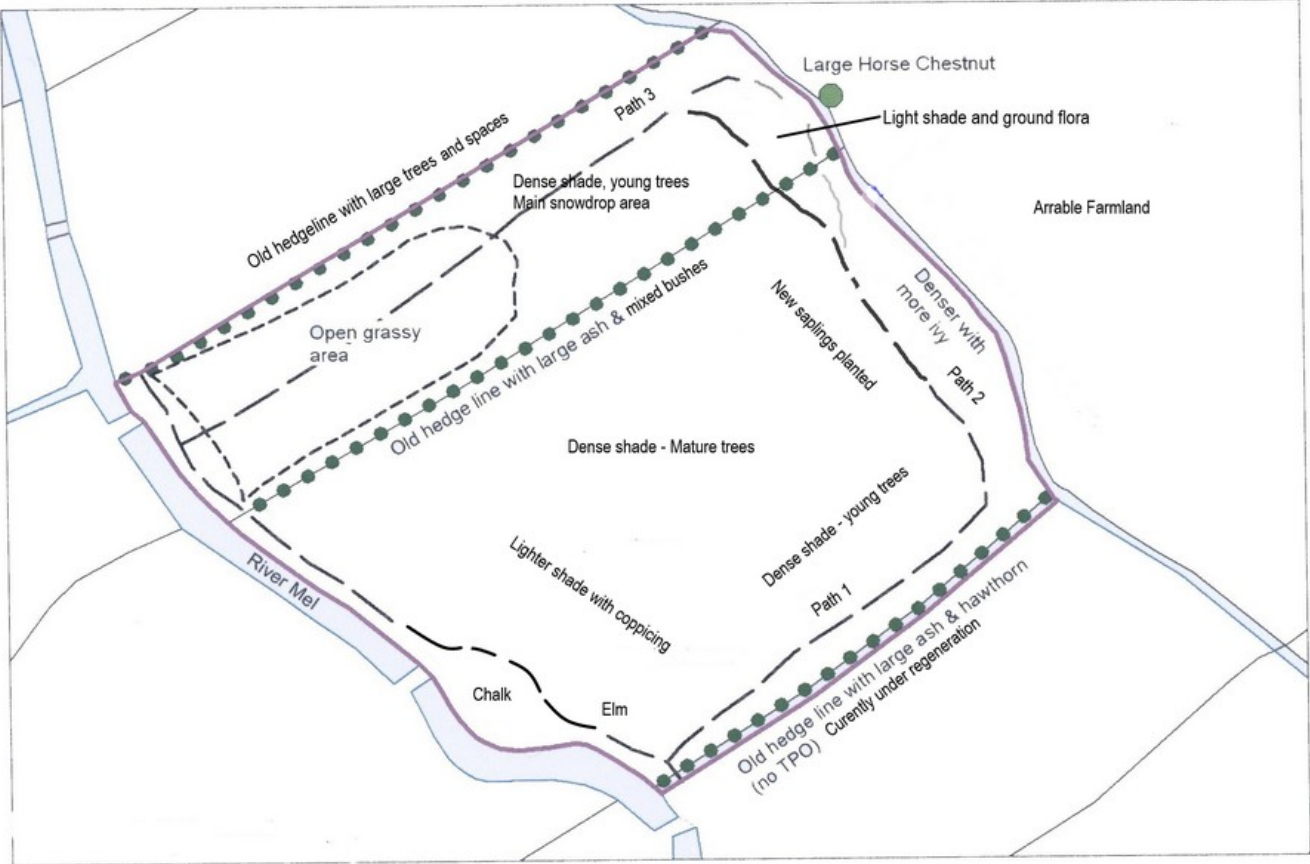

## Key

- Tree Protection Order (TPO) – Horse chestnut
- Hedge TPOs

# Appendix 3: Map 3 – Tree Protection Orders (marked in blue)



Reproduced from the 2008 Ordnance Survey mapping with the permission of the controller of Her Majesty's stationary office (c) Crown Copyright. Unauthorised reproduction infringes Crown Copyright and may lead to prosecution or civil proceedings.

Scale 1/1000  
Date 27/5/2010  
Centre = 537835 E 245945 N

# Appendix 3: Map 4 – Extent of orchards in 1887

Extent of orchards in Meldreth: OS map of 1887

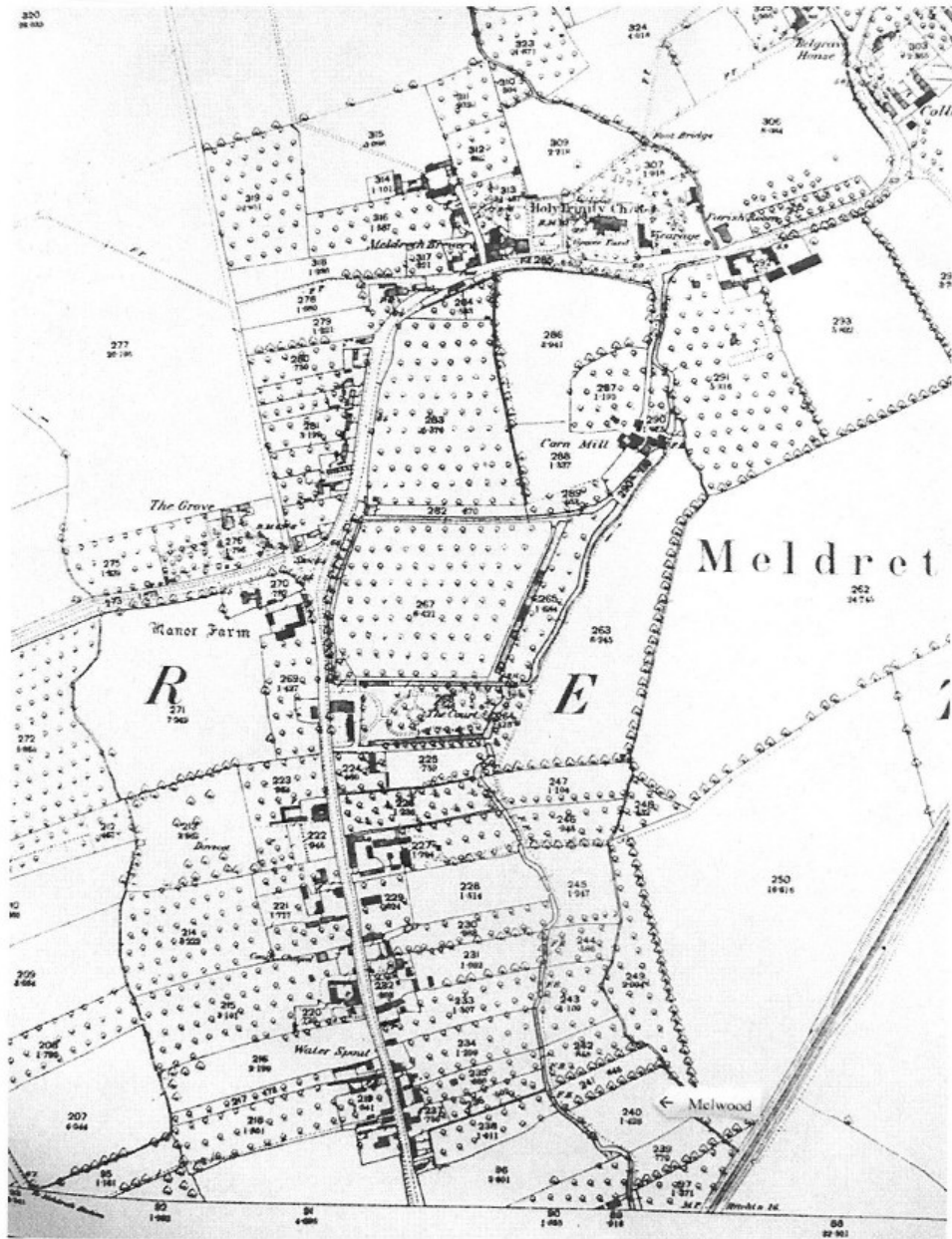

# Appendix 3: Map 5 – Inclosure Award Map (1821)



## **Appendix 4: Management Structure of Melwood Conservation Group**

The Melwood Conservation Group was started around 1986 by Miss Margaret Hunter. The group has been responsible for all of the management of Melwood to date.

The Melwood Conservation Group is affiliated to the Parish Council, from which it gains public liability insurance for volunteering activities and funding for management activities. Funding applications are agreed by the Parish Council on an annual basis.

The management committee of the Conservation Group meets a minimum of three times each year. The group appoints a chairman, minutes secretary, treasurer and conservation group leader each year. There are also three trustees appointed every year at the AGM.

It raises funds when necessary by making grant applications.

It is responsible for general maintenance activities and arranging a calendar of volunteer workparties in the wood throughout the year.

It organises events for the local community when appropriate.

The Melwood Conservation Group also includes a large number of supporters.

These include local people who treasure the woodland and feel strongly about its welfare and future, do not wish to be represented on the management committee but are keen to help with the work of maintenance and conservation.

## Appendix 5: Work Plan

The following work plan is an indication of what might be actioned each year. It is not prescriptive and the tasks will be adapted to match the circumstances as they arise, for instance fallen trees, and the availability of volunteers. The current COVID restrictions on working parties may affect the plans for 2021..

### 5 Year Management Plan 2021-2025: *Melwood Local Nature Reserve*

| Objective  | Task  | 2021 | 2022 | 2023 | 2024 | 2025 |
|--|---|------|------|------|------|------|
| <b>1) To maintain and enhance the different habitats of the site</b> |   |      |      |      |      |      |
| a) Woodland  | a) Maintain maps as work progresses   |      |      |      |      |      |
|  | b) Carry out selective small-scale coppicing / layering to increase density of shrub level.   |      |      |      |      |      |
|  | c) Carry out coppicing or pollarding of larger trees to allow more light to reach the woodland floor, create large deadwood habitat and encourage growth of grass and herbs |      |      |      |      |      |
|  | d) Review hedge lines and negotiate with S. Cambs DC if tree felling is considered  |      |      |      |      |      |
|  | e) Identify any trees that require attention under Health & safety site management regulations.   |      |      |      |      |      |

| Objective                          | Task   | 2021 | 2022 | 2023 | 2024 | 2025 |
|------------------------------------|--|------|------|------|------|------|
|                                    | f) Maintain delineation of the main circular path  |      |      |      |      |      |
|                                    | g) Fill gaps in yew hedge ??????   |      |      |      |      |      |
|                                    | h) Control ground ivy by cutting and pulling   |      |      |      |      |      |
|                                    | i) Encourage new growth of herbaceous plants by green mulch, seeding or planting   |      |      |      |      |      |
|                                    | j) Maintain litter rota  |      |      |      |      |      |
| <b>b) Grassland in the meadow.</b> | a) Mow the meadow and rake cuttings once a year in late summer.<br>Review timing annually and decide whether to cut half early and half later.<br>Use cuttings as "green hay" to enhance areas of reduced shade following tree work. |      |      |      |      |      |
|                                    | Review hedge lines, particularly western edge.<br>Thin crowns rather than fell if more light needed.   |      |      |      |      |      |
|                                    | Possibly allow bushes to mature on western edge then introduce hedge plants.   |      |      |      |      |      |
|                                    | Annually monitor grass near cut yews and decide if seeding needed.   |      |      |      |      |      |
|                                    | Review regularly enhancement of  |      |      |      |      |      |

| <b>Objective</b>   | <b>Task</b>  | <b>2021</b> | <b>2022</b> | <b>2023</b> | <b>2024</b> | <b>2025</b> |
|--|--|-------------|-------------|-------------|-------------|-------------|
|  | flora in the meadow area.  |             |             |             |             |             |
| <b>c) Riverside</b>  | Work with the River Mel Group and the Primary School to identify felling, pollarding, coppicing requirements                     |             |             |             |             |             |
| <b>2) To maintain and enhance the public access of the site for local people.</b>            | see 1f and 1g above  |             |             |             |             |             |
| <b>3) Involve the local community in the management of the site</b>                          |  |             |             |             |             |             |
|  | Recruit volunteers   |             |             |             |             |             |
|  |  |             |             |             |             |             |
|  | Send regular updates to "Meldreth Matters" and Melbourn Magazine   |             |             |             |             |             |
| <b>4) Enhance the interpretative/educational opportunities of the site for local people.</b> |  |             |             |             |             |             |
|  | Use temporary boards to explain on going major work  |             |             |             |             |             |
|  | Work with the Primary School and Village college on activities in the wood   |             |             |             |             |             |
| <b>5) Work with the River Mel Restoration Group</b>  | a) Keep neighbours and stakeholders informed of plans and progress in Melwood and Mel Meadow. Be aware of their long-term plans. |             |             |             |             |             |

| Objective   | Task  | 2021 | 2022 | 2023 | 2024 | 2025 |
|---|---|------|------|------|------|------|
| 6) Ensure that the agreed management plan is implemented and record all activities relating to the management plan. |   |      |      |      |      |      |
|   | a) Keep a management diary to record all work done on site.   |      |      |      |      |      |
|   | b) Undertake yearly monitoring of site management operations to ensure objectives are being met and to inform future management plan reviews. |      |      |      |      |      |